

HGS35 Linear Power Supply

The HGS Series of linear power supplies offers AC to DC power conversion. Packaged in an enclosed frame configuration, these power supplies offer:

- Very low output ripple and noise.
- Inherent low conducted and radiated noise levels.
- Line and Load regulation



Specifications:

Input Voltage (switch selectable):

120VAC **OR** 220VAC $\pm 10\%$
47 to 63 Hz

Output:

Rated power – maximum: 35 watts
 Output voltage adjustable: $\pm 10\%$
 Line Regulation: $< \pm 1.0\%$ maximum
 Load Regulation: $< \pm 1.0\%$ maximum

Protection:

Isolation Voltage (input - output): 3,000 VAC for 1 minute
 Isolation Voltage (input - FG): 2,000 VAC for 1 minute
 Over load protection – continuous 105 to 150%, auto reset
 Over voltage protection – continuous 105 to 150%, auto reset

Environmental:

Operating Temperature: 0°C to $+50^{\circ}\text{C}$
 Storage Temperature: -40°C to $+85^{\circ}\text{C}$
 Humidity (non-condensing): 90% RH

RoHS compliant

Model	Output Voltage	Output Current	Ripple/ Noise (p-p)	Efficiency (typical)
HGS35- 05	+5VDC	6.00A	$< 0.02\%$ mV	45%
HGS35- 12	+12VDC	3.00A	$< 0.02\%$ mV	55%
HGS35- 15	+15VDC	2.24A	$< 0.02\%$ mV	55%
HGS35- 24	+24VDC	1.50A	$< 0.02\%$ mV	60%

Physical – 129.0mm (5.1”) x 98.0mm (3.9”) x 38.0mm (1.5”):

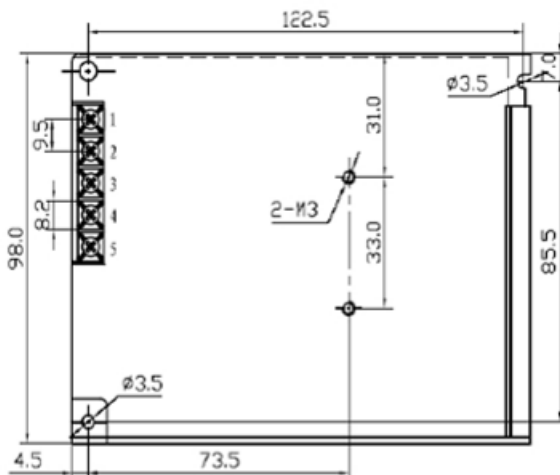

Custom power supply designs are available to meet the specific application requirements. For a no obligation technical evaluation, please provide the specific performance requirements to engineering@tichenassociates.com or the address below.